

GROUND ANCHOR PLATE PAP-45/4

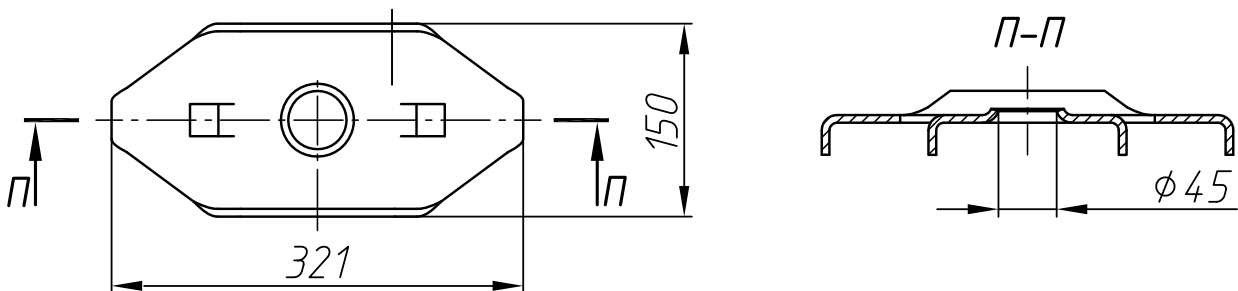

TECHNICAL CHARACTERISTICS:

Size:



Weight: 3,9 kg

Steel thickness: 12 mm

Coating: Zn / or steel without coating

Ground anchor plate specially designed according cell sizes of 2D-Geo chain-link mesh. Plate edges machined and curved to minimize mechanical damage to mesh on-load.